

**Low Head Socket Capscrews**  
**To ANSI B18.3**

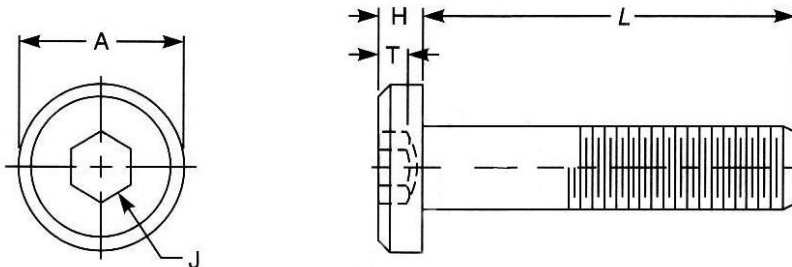

**Dimensional Data**

<b>Thread Size</b>	<b>T.P.I UNC</b>	<b>T.P.I UNF</b>	<b>Head Diameter (Max) A</b>	<b>Head Height (Max) H</b>	<b>Key Engagement (Min) T</b>	<b>Key Size J</b>	<b>Thread Length (Min)</b>	<b>Thread Length (Max)</b>
<b>4</b>	40	48	0.183	0.059	0.038	0.050	0.75	0.99
<b>5</b>	40	44	0.205	0.065	0.044	1/16	0.75	1.00
<b>6</b>	32	40	0.226	0.072	0.050	1/16	0.75	1.05
<b>8</b>	32	36	0.270	0.085	0.060	5/64	0.88	1.19
<b>10</b>	24	32	0.312	0.098	0.072	3/32	0.88	1.27
<b>1/4</b>	20	28	0.375	0.127	0.094	1/8	1.00	1.50
<b>5/16</b>	18	24	0.437	0.158	0.110	5/32	1.12	1.71
<b>3/8</b>	16	24	0.562	0.192	0.115	3/16	1.25	1.94
<b>7/16</b>	14	20	0.625	0.223	0.135	7/32	1.38	2.17
<b>1/2</b>	13	20	0.750	0.254	0.151	1/4	1.50	2.38
<b>5/8</b>	11	18	0.875	0.316	0.250	5/16	1.75	2.82